



### CHANGING FUSIBLE LINKS

The Kinetrol Fire Failsafe assembly includes a Fusible Link, which can be replaced as necessary.

During 2019 the design of the Fusible Link was changed from Type "A" to Type "B" as shown below.

Type "A" links are no longer available, therefore if replacement is necessary, the Type "B" link must be used.

Because the Type "B" link is shorter than Type "A", it must be used in conjunction with the later type Connecting Lever: Old Connecting Levers have their contact face at 90° to the lever axis, whereas new levers have this face angled as shown below.

Type "B" links, and new Connecting Levers are available from Kinetrol under the spare part numbers shown below. Type "B" links are common across the 05, 07, 09 and 12 model range, but Connecting Levers are model specific. The "D-Link" (SP845) is also available in case of loss or damage.

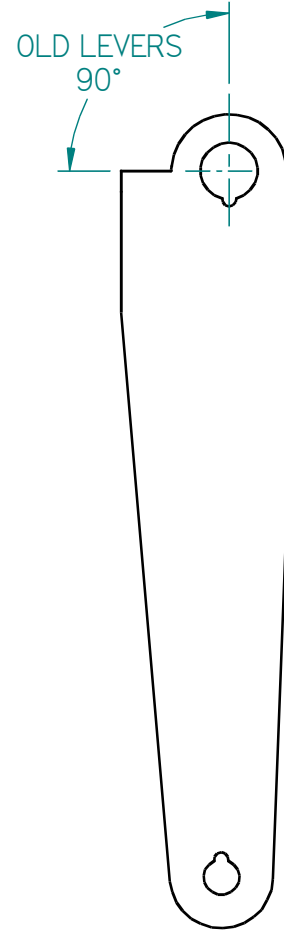

#### TYPE 'A': NO LONGER AVAILABLE

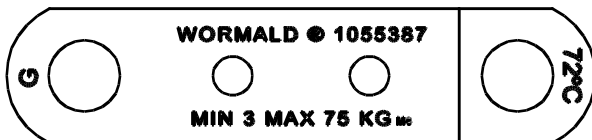

DRAWINGS SHOWN APPROXIMATELY AT FULL SIZE  
(09 LEVER SP843 SHOWN)

#### TYPE 'B': 74°C SP838 100°C SP839

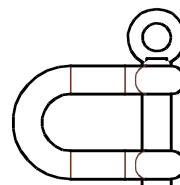
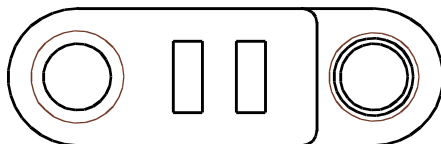

SP845

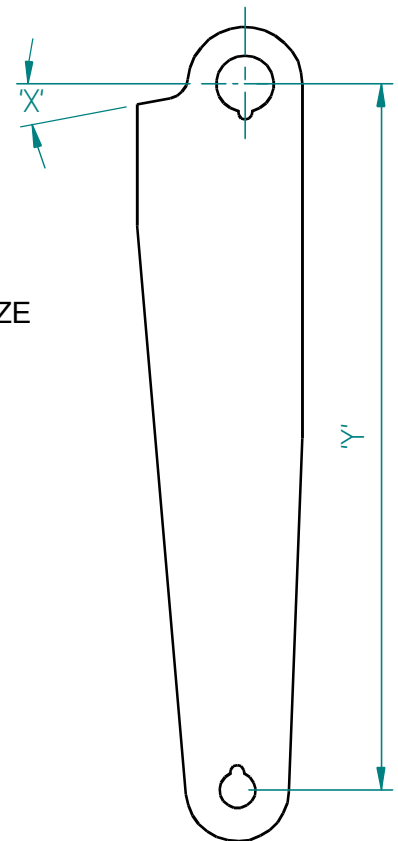

SP842 (05&07), SP843 (09), SP844 (12)

	SP842	SP843	SP844
X	15°	11°	7°
Y	66.70	99.58	141.5